

“Red Bean”

Silicone Lunch Box

User Manual

Product Model: O-2025-01

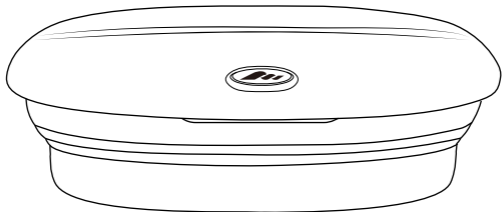

- Please use according to the corresponding model, subject to the actual product.
- Please read this manual carefully before use and keep it properly for future reference.

Product Dimension Description

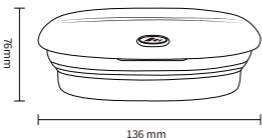

Before folding

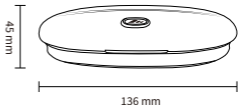

After folding

Product Opening Method

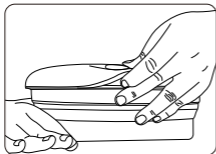

1. Hold the container with one hand, and align the fingers of the other hand with the protrusion at the buckle joint.

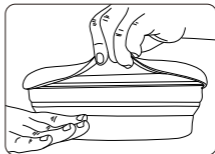

2. Keep holding the container, align your fingers with the raised part, then lift upward to separate the lid from the container.

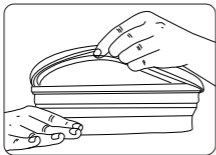

3. Continue to lift the lid upward.

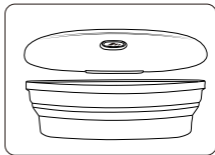

4. Fully open the lid.

Product Buckle Closing Method



1. Support the container with your fingers, then press both left and right sides.

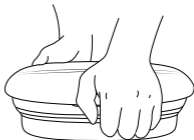

2. Support the container with your fingers, press the front and rear sides.



3. Support the box body with your fingers, then press the remaining unfastened part.



4. Buckling completed

Product Unfolding Method

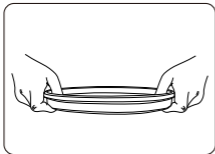

1. Hold both sides of the lunch box with both hands, press inward with your thumbs, and pull outward with your four fingers to unfold the folded box body.

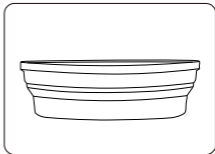

2. Fully unfold the lunch box to form a three-dimensional usable state.

Product Folding Method

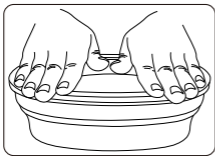

1. Press down from the top of the opened lunch box with both hands to fold the box body gradually.

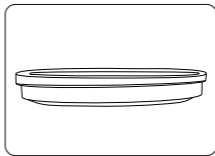

2. The lunch box is fully folded into a flat plate shape, reducing its volume for easy storage.

Lid Closing Method in Product Folded State

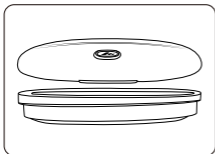

1. Align the matching lunch box lid and place it over the opening of the folded lunch box.

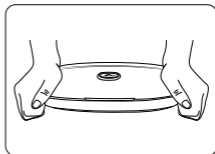

2. Press the buckles on both side edges of the lid with both hands, hold the bottom, and fasten it downward.

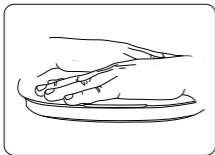

3. Press the surface of the lid with both hands to fasten the remaining positions.

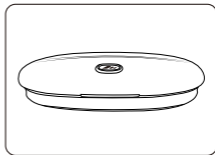

4. The lid is tightly fastened onto the folded lunch box, keeping the whole item flat and sealed.

Product Parameters

Product Name	Red Bean Silicone Lunch Box
Product Model	O-2025-01
Product Dimensions	Before folding: 215*136*76mm After folding: 215*136*45mm
Product Weight	342g \pm 5g
Applicable Temperature Range	-50°C ~ 200°C
Product Color	Red and white color matching

Usage Method

1. Unfold the lunch box: Pull upward on the edge of the box opening from the folded state to fully expand the box to its normal height.
2. Folding for storage: Clean and dry the lunch box after use, then press the box body vertically downward until it is flat (the thickness is about 1/2 of the original height).
3. Sealing and opening: After closing the lid, support the box with your fingers and press the two longer sides. Fasten the two sides first, then press the remaining parts. The lunch box can be opened from the longer sides in the same way.
4. Microwave heating: Open the exhaust valve on the lid or leave the lid slightly ajar before heating. Do not heat in a fully sealed state. Use heat-resistant gloves when taking it out to avoid scalding.
5. Refrigerator freezing and high-temperature disinfection: It can be directly placed in the refrigerator, disinfected by boiling in hot water, or cleaned in a dishwasher at high temperature.

Cleaning and Maintenance

1. Please clean and boil the product, then pour out the water, repeat 1 to 2 times before first use.
2. Silicone material has static adsorption. Do not place the lunch box in areas with excessive lint and dust.
3. Avoid heavy compression or keeping the lunch box in a twisted and compressed state for a long time (normal folded storage is not affected).
4. When the product gets stained, clean it with toothpaste or clean water and a soft cloth. Never use steel wool.
5. Rinse thoroughly with clean water after use, wipe dry with a dust-free cloth, or wash in warm water and dry, then place in a well-ventilated area to air dry.
6. If stained with dark-colored food (such as curry, ketchup) or with peculiar odors, soak in baking soda water for 15 minutes before rinsing.

Precautions

1. The silicone temperature resistance ranges from -50°C to 200°C . Do not use it beyond this range.
2. Do not expose the product to high temperatures or open flames for a long time to prevent silicone aging and deformation.
3. Avoid contact with sharp objects (such as knives, forks and chopstick tips), which may scratch or puncture the product.
4. Be sure to open the exhaust valve or slightly lift the lid during microwave heating. Fully sealed heating is strictly prohibited.
5. Immediately stop using the product if damage, cracks, stickiness or severe deformation is found.
6. Do not allow children to play with this product alone to prevent risks of swallowing fasteners or suffocation.
7. Keep away from strong acid, strong alkali chemicals and sharp cutlery to prevent material damage.
8. Do not heat the product directly over an open flame.